

# SOFFITS

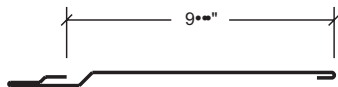

## FLEXLOC®

Available in a 9½-inch width, the FlexLoc® panel is clipped down to a waterproofed solid substrate, when used in roof applications.

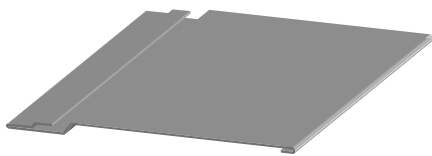

### Features and Benefits:

- Because the panels are generally run parallel to the curved surface, no pre-curving of the FlexLoc® panel is required.
- For the designer who wants a barrel vault with a smooth look (no standing seams) and horizontal lines instead of vertical, curved FlexLoc® is the recommended product. It's ideal for curved applications or soffits.
- FlexLoc® is a non-structural panel.

### Product Specifications

- **Applications:** Roof, Fascia, Soffit
- **Coverage Widths:** 9½"
- **Panel Attachment:** Concealed Fastening System
- **Gauges:** 24 (standard); 22 (optional)
- **Finishes:** Smooth (standard); Embossed (optional)
- **Coatings:** Galvalume Plus®, Signature® 200, Signature® 300, Signature® 300 Metallic

[www.mbc.com](http://www.mbc.com) | [shop.mbc.com](http://shop.mbc.com)



HOUSTON | 281.407.6915  
ADEL, GA | 888.514.6062  
ATLANTA | 678.337.1619  
ATWATER, CA | 209.445.3891

ENNIS, TX | 469.256.8255  
INDIANAPOLIS | 317.364.4329  
LUBBOCK, TX | 806.224.2724

MEMPHIS, TN | 662.298.2337  
OKLAHOMA CITY | 405.492.6968  
PHOENIX | 480.630.3022

ROME, NY | 315.371.4330  
SALT LAKE CITY | 385.715.2952  
SAN ANTONIO | 210.888.9768

Descriptions and specifications contained herein were in effect at the time this publication was approved for printing. In a continuing effort to refine and improve products, MBCI reserves the right to discontinue products at any time or change specifications and/or designs without incurring obligation. To ensure you have the latest information available, please inquire or visit our website at [www.mbc.com](http://www.mbc.com). Application details are for illustration purposes only and may not be appropriate for all environmental conditions, building designs or panel profiles. Projects should be designed to conform to applicable building codes, regulations and accepted industry practices. If there is a conflict between this manual and project erection drawings, the erection drawings will take precedence. MBCI's insulated metal panel product line is manufactured by Metl-Span®.